

Submittal Data Sheet

Features

- Manifold outlet is 1”-11-½ NPSM RH-INT.
- High quality brass master shut-off valve included.
- Flexible 72” CGA specific pigtails ¾” ID urethane wrapped nylon lined, rated for 2,250 psi.
- 400 psi relief valve with ¾” fnt pipe away adaptor.
- Wall mounting brackets included.
- CGA specific check valve connections and gas tight cap & chains.
- Cleaned for use with oxygen in accordance with CGA G4.1.
- Tested and built in accordance with CGA and NFPA 99 guidelines.
- Made in the USA.

Ordering Information

Easy to use modular ordering system.

LBLL, LBL, or LCL to specify the Liquid By Liquid Header that meets your needs.

Model Numbering:

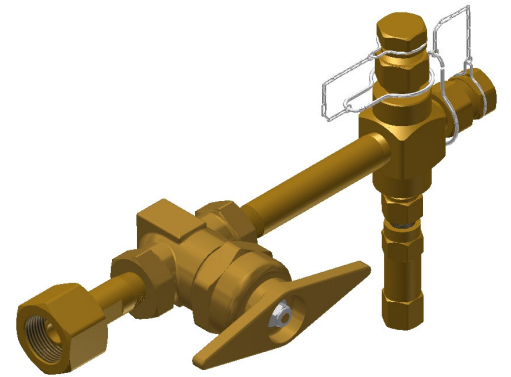

N = Number of Ports on Each Header

- | | | | | | | | |
|----|----|----|----|----|----|----|----|
| 01 | 02 | 03 | 04 | 05 | 06 | 07 | 08 |
|----|----|----|----|----|----|----|----|

G = Gas Type

- | | | |
|----------------------|-------------------|-------------------|
| 320 – Carbon Dioxide | 346 – Medical Air | 580 – Inert Gases |
| 326 – Nitrous Oxide | 540 – Oxygen | |

C = Control Type

- | | | |
|--|--|--|
| LBLL – Left Side Only
Used with PLU & PLC Series | LBL – Includes Right & Left Side Headers
Used with LU Series | LCL – Canadian; Includes Right & Left Side Headers; Used with LC Series |
|--|--|--|

Part No. Examples

PX-LBL540012XXN72 = Features right & left side headers with one Oxygen port on each header.

PX-LBLL540012XXN72 = Features left side header only with one Oxygen port on the header.