

MVECT1005xx1

MVAC ENCLOSURE 10 HP TRIPLEX CLAW 200G TANK

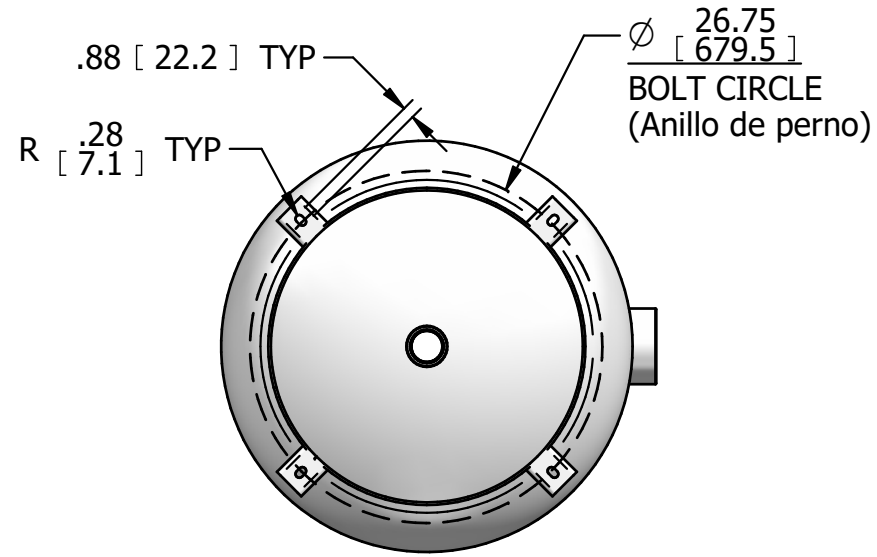

FLOOR MOUNTING SLOTS  
(Ranuras de Montaje)

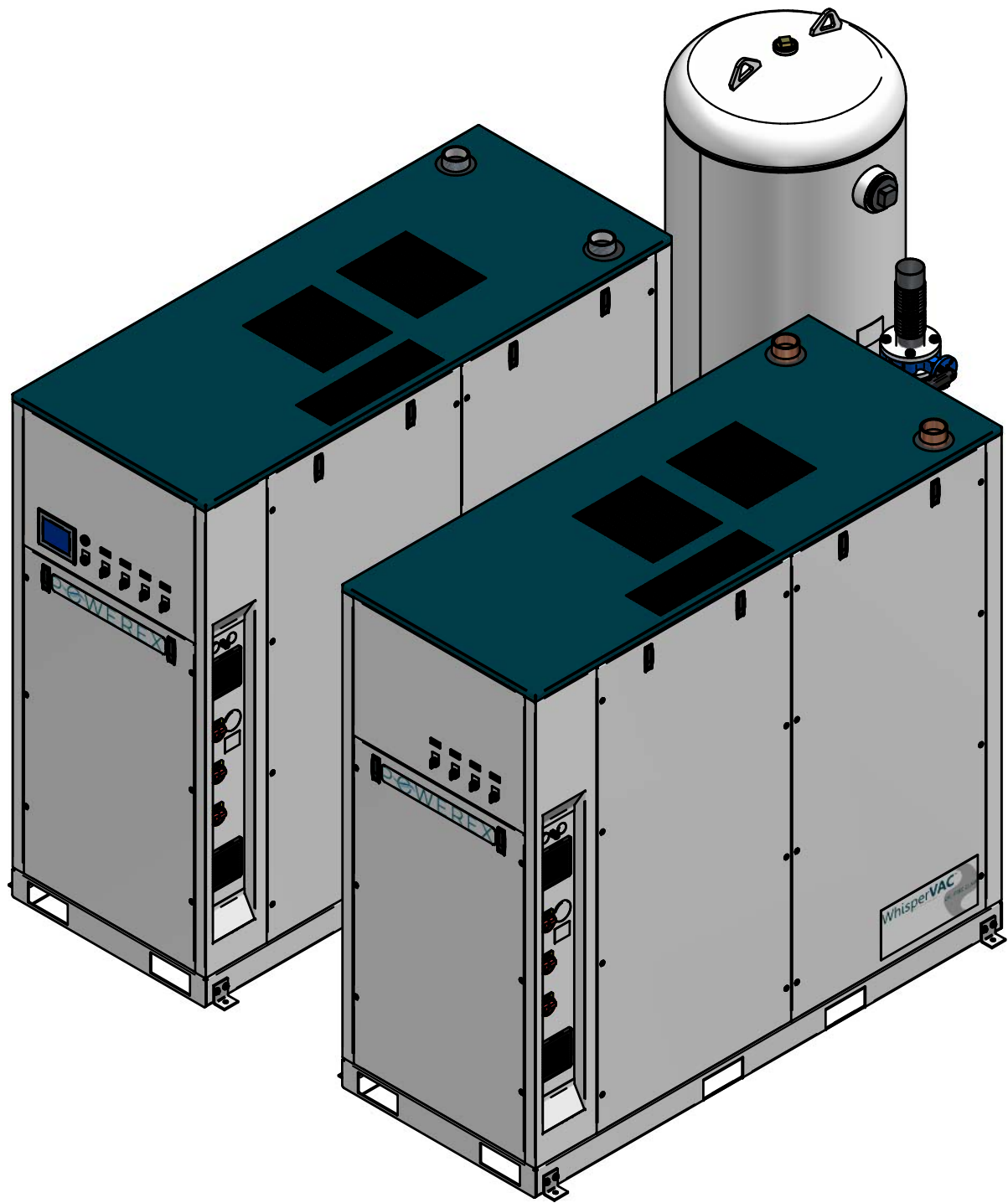
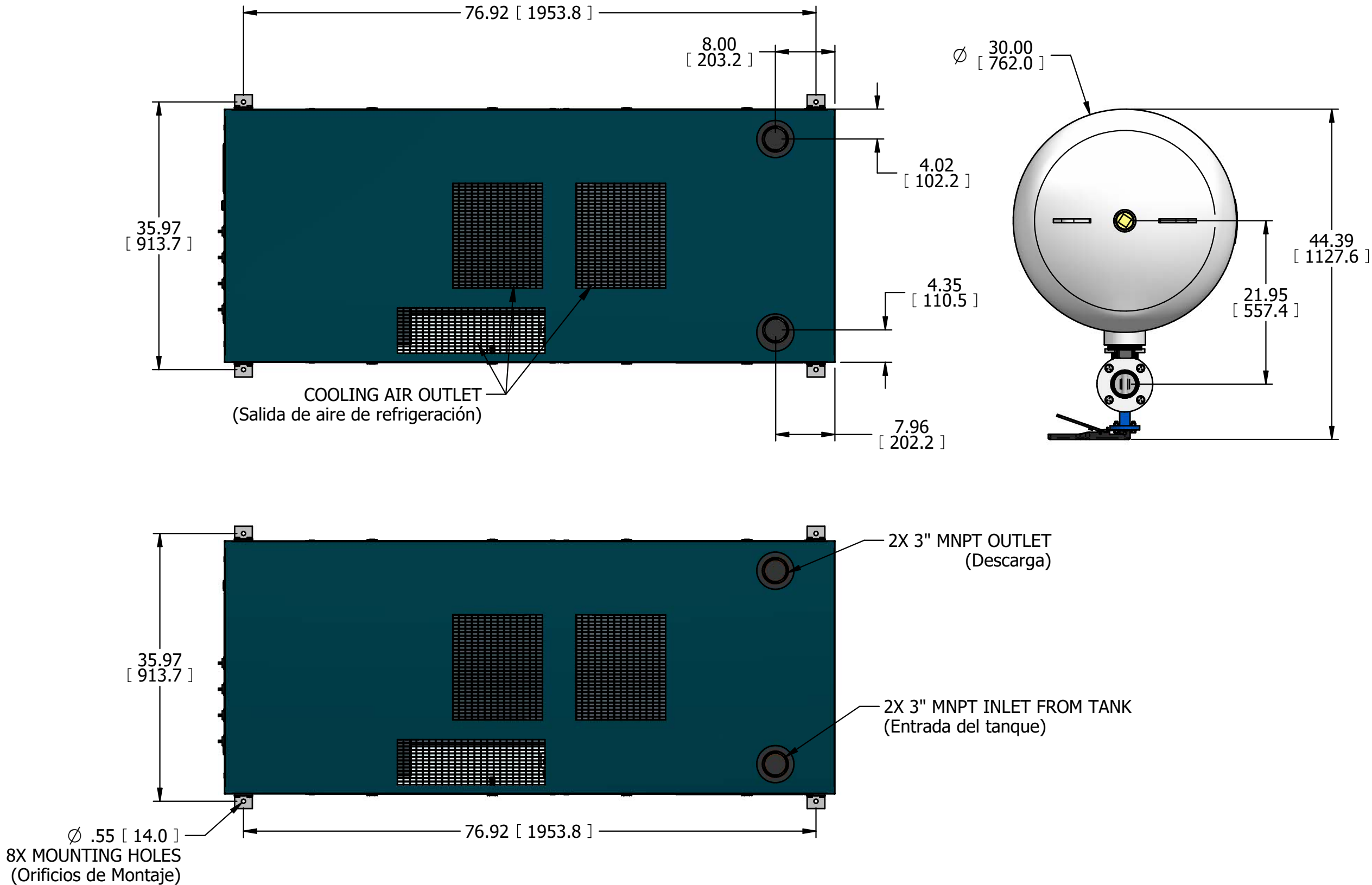

ISO VIEW

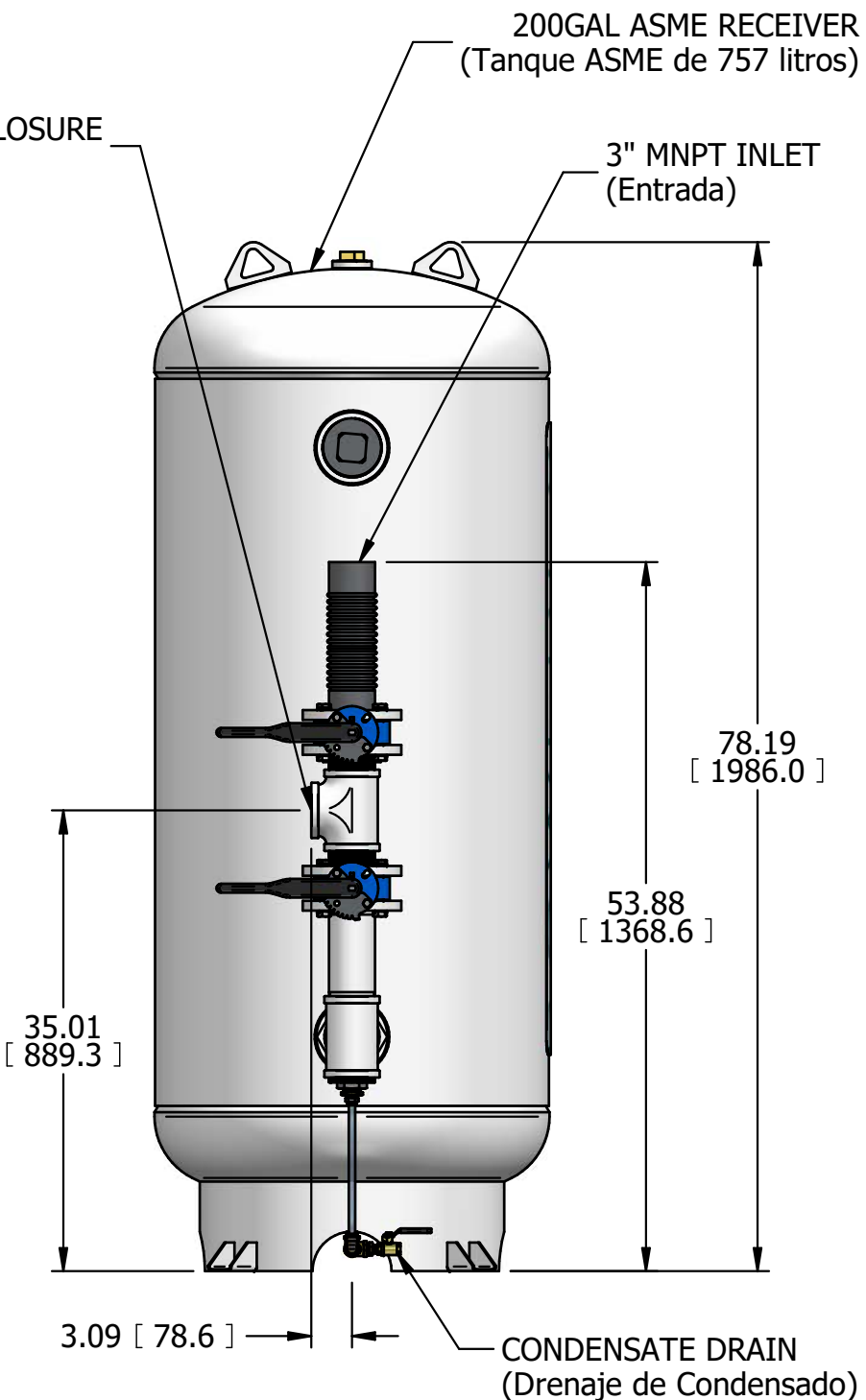
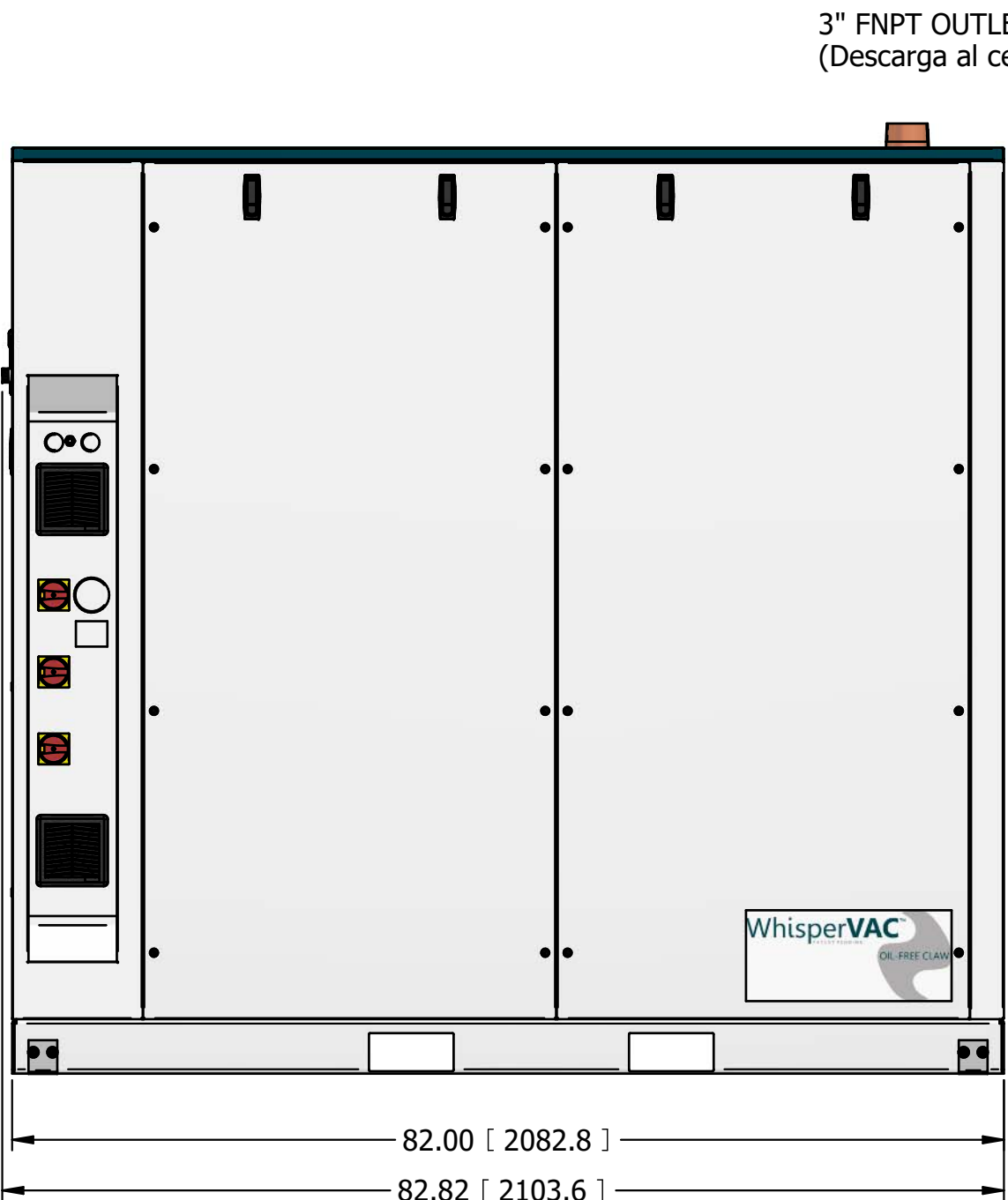
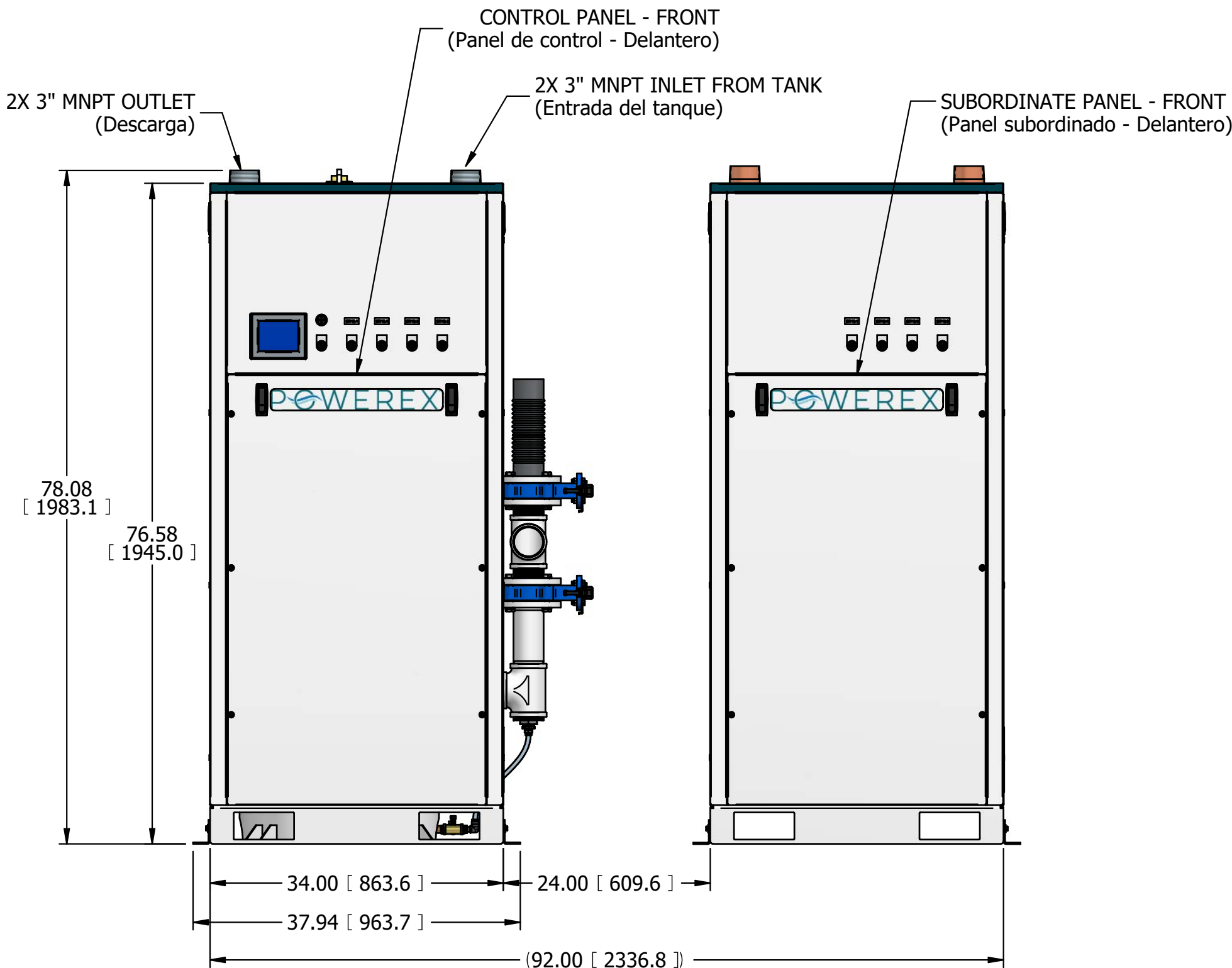

- NOTES:
1. APPROXIMATE WEIGHT: 5326 LBS
  2. A MINIMUM OF 24" CLEARANCE IS RECOMMENDED AROUND THE ENTIRE UNIT. CLEARANCE FOR CONTROL PANEL SHALL BE IN ACCORDANCE WITH OSHA/NEC REQUIERMENTS.
  3. ALL PLUMBING FROM TANK OUTLET TO ENCLOSURE INLET(S) SHALL BE FIELD-SUPPLIED.
  4. SYSTEM DESIGNED IN COMPLIANCE WITH U.S. NFPA '99, LATEST EDITION.
1. PESO APROXIMADO: 2415 kg
2. RECOMENDAMOS QUE EL ESPACIO LIBRE ALREDEDOR DEL SISTEMA DEBE SER COMO MÍNIMO 24" (600 mm). EL ESPACIO LIBRE PARA EL TABLERO DE CONTROL DEBERÁ ESTAR DE ACUERDO CON LOS REQUERIMIENTOS DE SEGURIDAD DE LA OSHA/NEC.
3. TODA LA PLOMERÍA DESDE LA DESCARGA DEL TANQUE HASTA LA(S) ENTRADA(S) DEL CERCADO DEBE SER SUMINISTRADA POR EL CLIENTE.
4. EL SISTEMA ESTÁ DISEÑADO DE ACUERDO CON LA ÚLTIMA EDICIÓN DE LA NFPA 99.

REVISION NOTES				
DESCRIPTION	ECN	PR/NOR		
RELEASE TO PRODUCTION	PXEC0481	XXXXXXXX		

SYMBOL LEGEND	DRAWINGS TO CONFORM TO CURRENT REVISION OF THE FOLLOWING STANDARDS:			
	Y14.3 MULTI AND SECTIONAL VIEW DWGS			
	Y14.5 DIMENSIONING AND TOLERANCING			
TOLERANCES, UNLESS OTHERWISE SPECIFIED	SOLID EDGE DRAWING	DO NOT SCALE DRAWING FOR DIMENSIONS		
0.XX ± .05	INCH [mm]	SHEET 1 OF 2	SCALE 1:14	
0.XXX ± .005				
± .1				
CONFIDENTIAL DISCLOSURE		AUTHOR	REVISION DATE	APPROVALS ON FILE IN PLM
This drawing is the property of POWEREX or the SCOTT FEIZER COMPANY and is subject to return on demand. Its contents are confidential and must not be copied or submitted to outside parties for use or examination.		bkiplinger	1/12/2024	
ITEM ID: 752119		POWEREX™		
MATERIAL: N/A		150 PRODUCTION DRIVE, HARRISON OH 45030 (888) 789-7979		
DESCRIPTION: MVAC ENCLOSURE 10 HP TRIPLEX CLAW 200G TANK		DRAWING NUMBER: MVECT1005xx1	REVISION: A	SIZE: D

# MVECT1005xx1

MVAC ENCLOSURE 10 HP TRIPLEX CLAW 200G TANK

## REVISION NOTES

DESCRIPTION	ECN	PR/NOR
RELEASE TO PRODUCTION	PXEC0481	XXXXXXXX

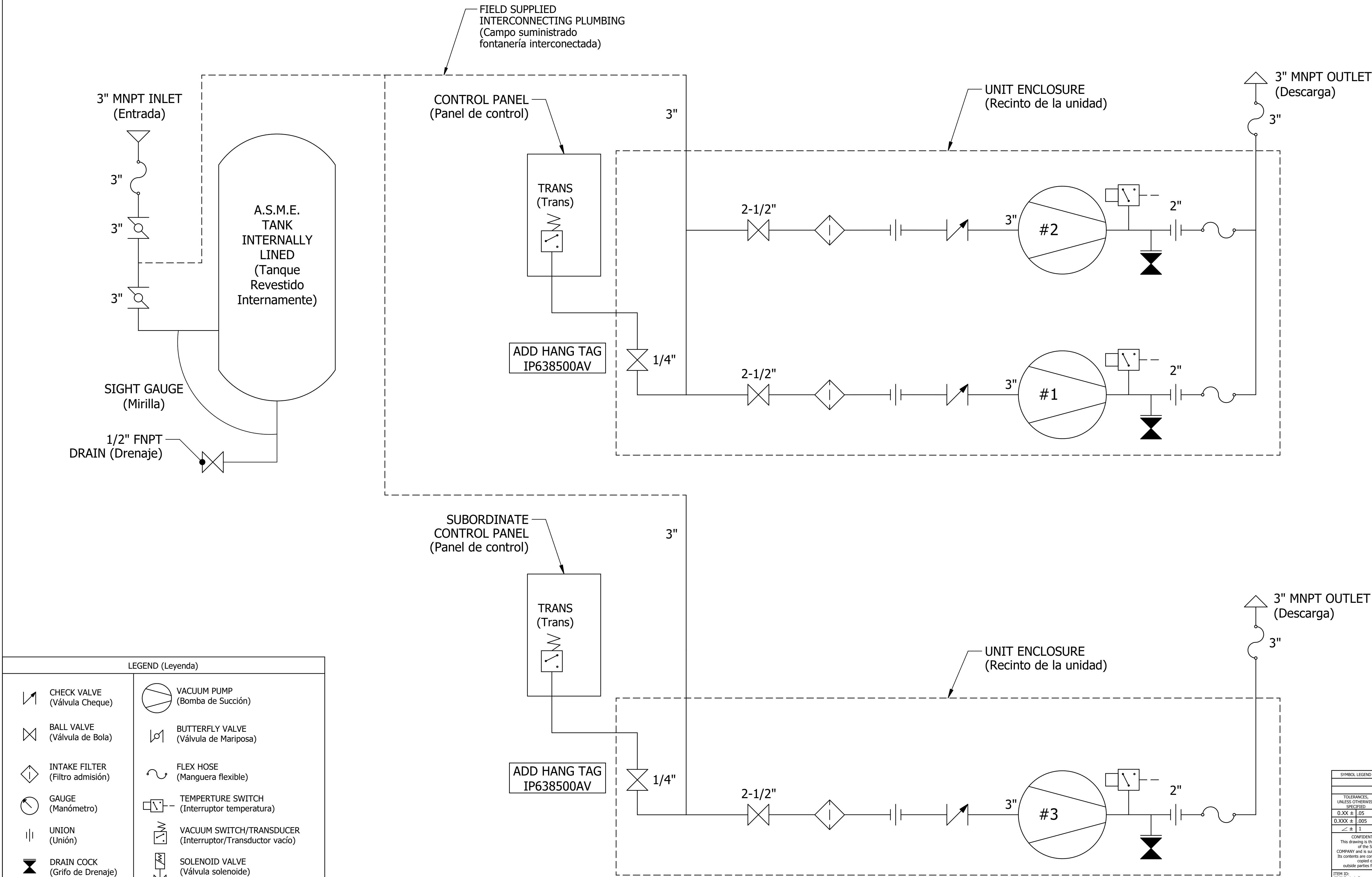

## LEGEND (Leyenda)

	CHECK VALVE (Válvula Cheque)		VACUUM PUMP (Bomba de Succión)
	BALL VALVE (Válvula de Bola)		BUTTERFLY VALVE (Válvula de Mariposa)
	INTAKE FILTER (Filtro admisión)		FLEX HOSE (Manguera flexible)
	GAUGE (Manómetro)		TEMPERTURE SWITCH (Interruptor temperatura)
	UNION (Unión)		VACUUM SWITCH/TRANSDUCER (Interruptor/Transductor vacío)
	DRAIN COCK (Grifo de Drenaje)		SOLENOID VALVE (Válvula solenoide)
	AIR LINE (Tubería de Aire)		CONDENSATE LINE (Línea de Condensado)

SYMBOL LEGEND	DRAWINGS TO CONFORM TO CURRENT REVISION OF THE FOLLOWING		
	AND STANDARDS:		
	Y14.3 MULTI AND SECTIONAL VIEW DWGS		
	Y14.5 DIMENSIONING AND TOLERANCING		
TOLERANCES, UNLESS OTHERWISE SPECIFIED	SOLID EDGE DRAWING	DO NOT SCALE DRAWING FOR DIMENSIONS	
0.XX ± 1.05			
0.XXX ± .005	INCH [mm]	SHEET 2 OF 2	SCALE 1:1
± 1			
CONFIDENTIAL DISCLOSURE			
This drawing is the property of POWEREX or the SCOTT FEIZER COMPANY and is subject to return on demand. Its contents are confidential and must not be copied or submitted to outside parties for use or examination.			
ITEM NO: 752119	AUTHOR		
MATERIAL: N/A	REVISION DATE		
DESCRIPTION: MVAC ENCLOSURE 10 HP TRIPLEX CLAW 200G TANK	bkiplinger 1/12/2024		
DRAWING NUMBER: MVECT1005xx1	APPROVALS ON FILE IN PLM		
	150 PRODUCTION DRIVE, HARRISON OH 45030 (888) 769-7979		
	REVISION		
	SIZE		
	A D		

POWEREX™